



*Certificata secondo la norma europea EN1935:2002 e CUAP 04.05/12 v. 2006 e testata al fuoco secondo la normativa europea EN 1634.1

*Certificada según norma europea EN1935:2002 y CUAP 04.05/12 v. 2006 y testada al fuego según la normativa europea EN 1634.1

*Li Euro-Norm EN 1935:2002 und CUAP 04.05/12 v. 2006 zertifiziert. Li Euro-Norm EN 1634.1 für Feuerwiderstand 30 Min. getestet

*Certified in conformity with the European standards EN1935:2002 and CUAP 04.05/12 v. 2006 and fire tested for 30 min. in conformity with the European standard EN 1634.1 for fire resistance

*Certifiée selon la norme européenne EN1935:2002 et CUAP 04.05/12 v. 2006 et testée à l'épreuve du feu selon la norme européenne EN 1634.1

*Deurscharnier gecertificeerd volgens norm EN 1935:2002 en CUAP 04.05/12 v. 2006, brandwerend getest en deurscharnier gecertificeerd volgens norm EN 1634.1

Istruzioni di Montaggio - Instrucciones de montaje - Montageanleitung - Assembling Instructions - Instructions de Montage - Montagehandleiding

CE	Krona Koblenz SpA Via Romero, 1 47853 Coriano	12
0757	ETA-11/0477	4 7 6 1 1 4* 1 13
0757-BPR-229-12-012	HINGES DO NOT CONTAIN HARMFUL SUBSTANCES	KUBI7 K7120

*4 for CS, NS finishing - 3 for EA finishing

*Consigliata per porte: spessore min. 40 mm
altezza max 2400 mm - larghezza max 900 mm.
*Aconsejada para puertas: esp. min. 40 mm
altura max 2400 mm - ancho max 900 mm.
*Anwendbar für Türen: Stärke min. 40 mm
Höhe max 2400 - Breite max 900 mm.
*Recommended for doors: thickness min. 40 mm
height max 2400 mm - width max 900 mm.
*Recommandé pour portes: épaisseur min. 40 mm
hauteur max 2400 mm - largeur max 900 mm.
*Aanbevolen bij deurenbreedtes: dikte min. 40 mm
hoogte max 2400 mm - breedte max 900 mm.

Fornita - Suministrada - Inbegriffen
Included - Incluir - Inclusief
TSPIC Ø5x MIN.35 DIN 7505-A
In alternativa utilizzare le viti non fornite:
En alternativa, utilizar tornillos no suministrados:
Als Alternative folgende Schrauben benutzen:
As an alternative, use the following screws:
Comme alternative utiliser des vis non fournies:
Gebruik als alternatief de volgende schroeven:
TSPIC M5x MIN.35 UNI7688 DIN965
TSPEI M5x MIN.35 UNI5933 DIN7991
TSPIT M5x MIN.35 UNI6109 DIN963
TSPIC M5x MIN.35 UNI8113 DIN7500-M

Regolazioni:
- Verticali ± 3 mm
- Orizzontali + 3 / - 2 mm
- Profondità ± 1 mm

Regulaciones:
- Verticales ± 3 mm
- Horizontales + 3 / - 2 mm
- Profundidad ± 1 mm

Justierungen:
- Senkrecht ± 3 mm
- Horizontal + 3 / - 2 mm
- Tiefe ± 1 mm

Adjustments:
- Vertical ± 3 mm
- Horizontal + 3 / - 2 mm
- Depth ± 1 mm

Réglages:
- Vertical ± 3 mm
- Horizontal + 3 / - 2 mm
- Profondité ± 1 mm

Regelbaarheid:
- Vertikaal ± 3 mm
- Horizontaal + 3 / - 2 mm
- Diepte ± 1 mm

*Minimo R=2 oppure smusso 2x45°
*Minimo R=2 o bien chaflán 2x45°
*Minimal R=2 oder abgerundet 2 x 45°
*Minimal R=2 or rounded 2x45°
*Minimal R=2 ou rondi 2x45°
*Minimaal R=2 ofwel afronding 2x45°

*Minimo R=2 oppure smusso 2x45°
*Minimo R=2 o bien chaflán 2x45°
*Minimal R=2 oder abgerundet 2 x 45°
*Minimal R=2 or rounded 2x45°
*Minimal R=2 ou rondi 2x45°
*Minimaal R=2 ofwel afronding 2x45°

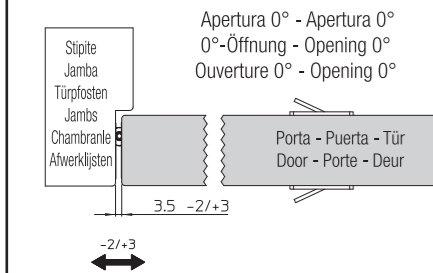

Apertura 90° - Apertura 90°
90°-Öffnung - Opening 90°
Ouverture 90° - Opening 90°

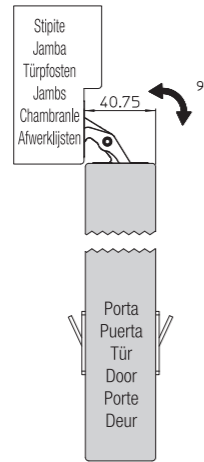

Apertura 180° - Apertura 180°
180°-Öffnung - Opening 180°
Ouverture 180° - Opening 180°

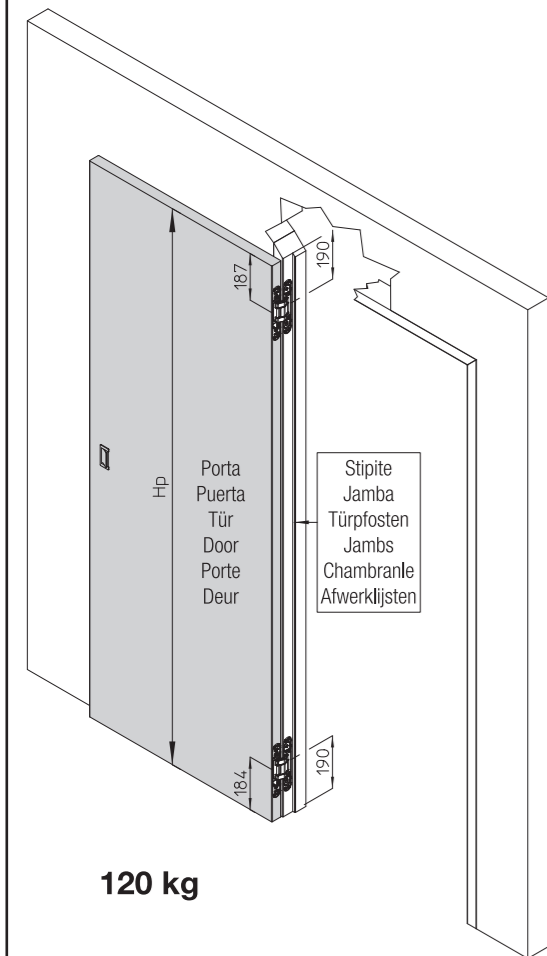
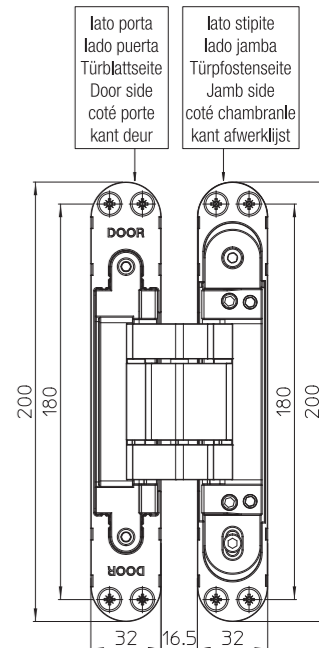
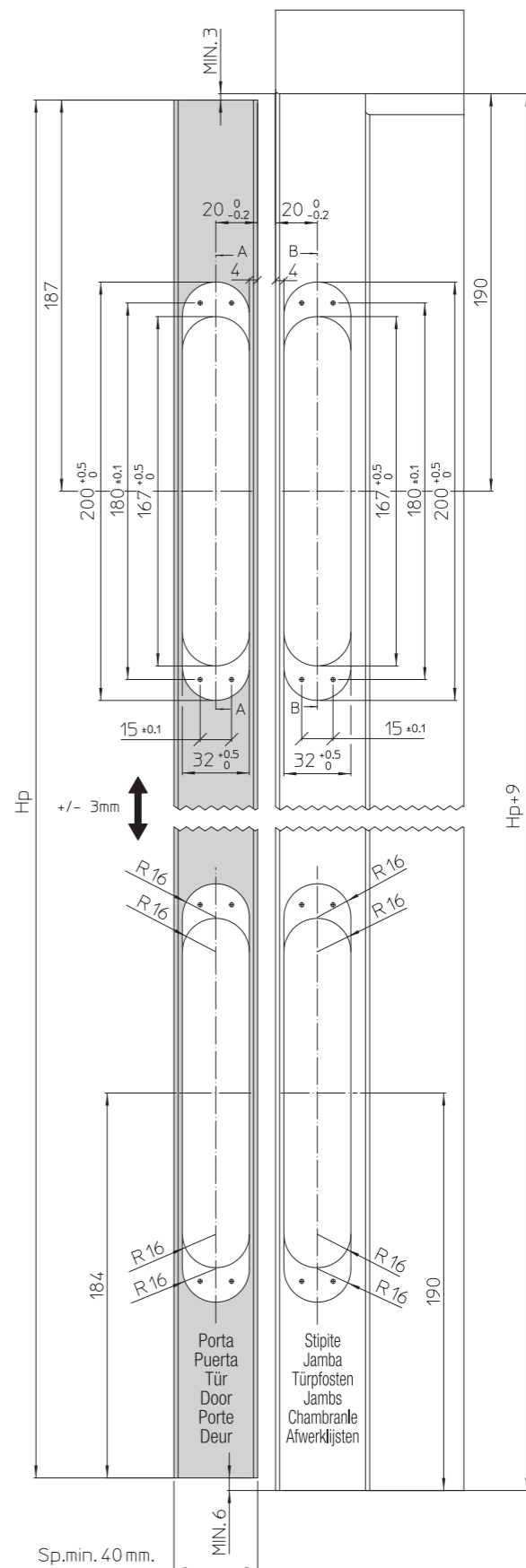
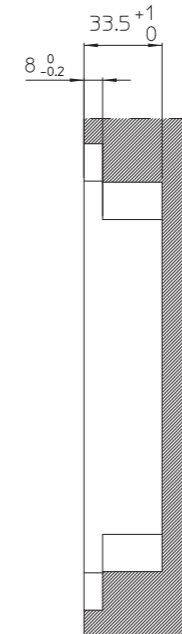
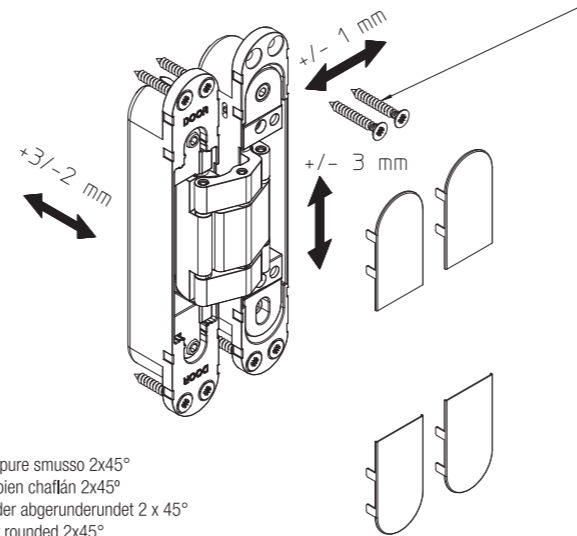
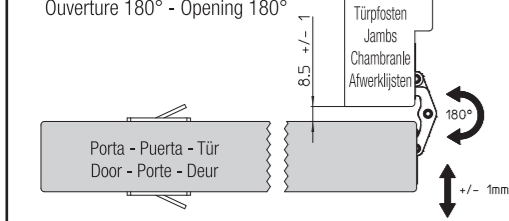

120 kg

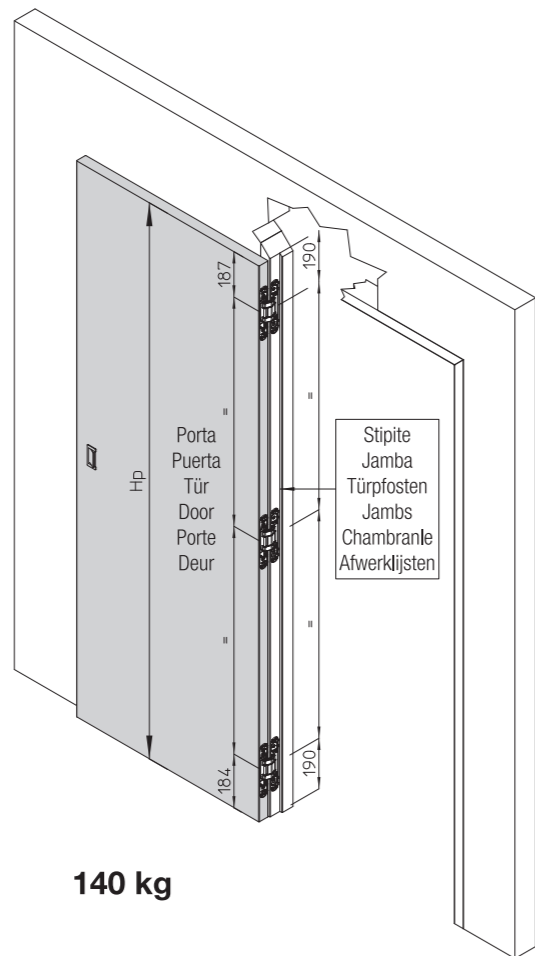

140 kg

Applicazione n° 2 cerniere - Aplicación 2 bisagras
Anwendungsmöglichkeit 2 Scharniere
Application no 2 hinges - Application 2 charnières
Toepassing 2 scharnieren

Applicazione n° 3 cerniere - Aplicación 3 bisagras
Anwendungsmöglichkeit 3 Scharniere
Application no 3 hinges - Application 3 charnières
Toepassing 3 scharnieren

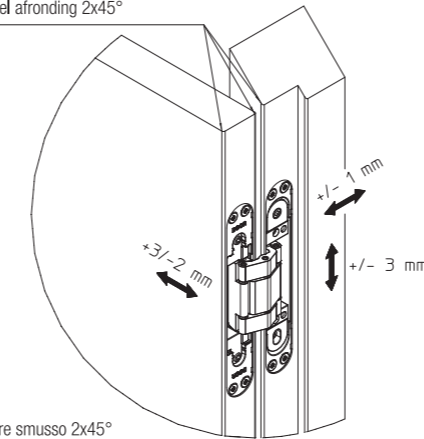

*Montaggio su porta
apertura destra a spingere
*Instalación en puerta
apertura derecha empujar
*Montage auf Türblatt
Öffnungsrichtung rechts in Druckrichtung
*Mounting on door leaf
RH opening direction push
*Installation sur vantail
direction d'ouverture droite à pousser
*Montage op een deurblad
dat men rechts opendruwt

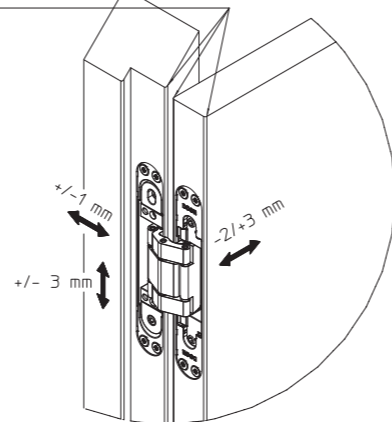

*Montaggio su porta
apertura sinistra a spingere
*Instalación en puerta
apertura izquierda empujar
*Montage auf Türblatt
Öffnungsrichtung links in Druckrichtung
*Mounting on door leaf
LH opening direction push
*Installation sur vantail
direction d'ouverture gauche à pousser
*Montage op een deurblad
dat men links opendruwt

Hp= altezza porta
Sp= spessore porta

Hp= Türblatthöhe
Sp= Türblatstärke

Hp= hauteur porte
Sp= épaisseur porte

Hp= altura puerta
Sp= espesor puerta

Hp= door-leaf height
Sp= door thickness

Hp= deur hoogte
Sp= deur dikte

