

Für diese Unterlage behalten wir uns alle Rechte nach DIN 34 vor

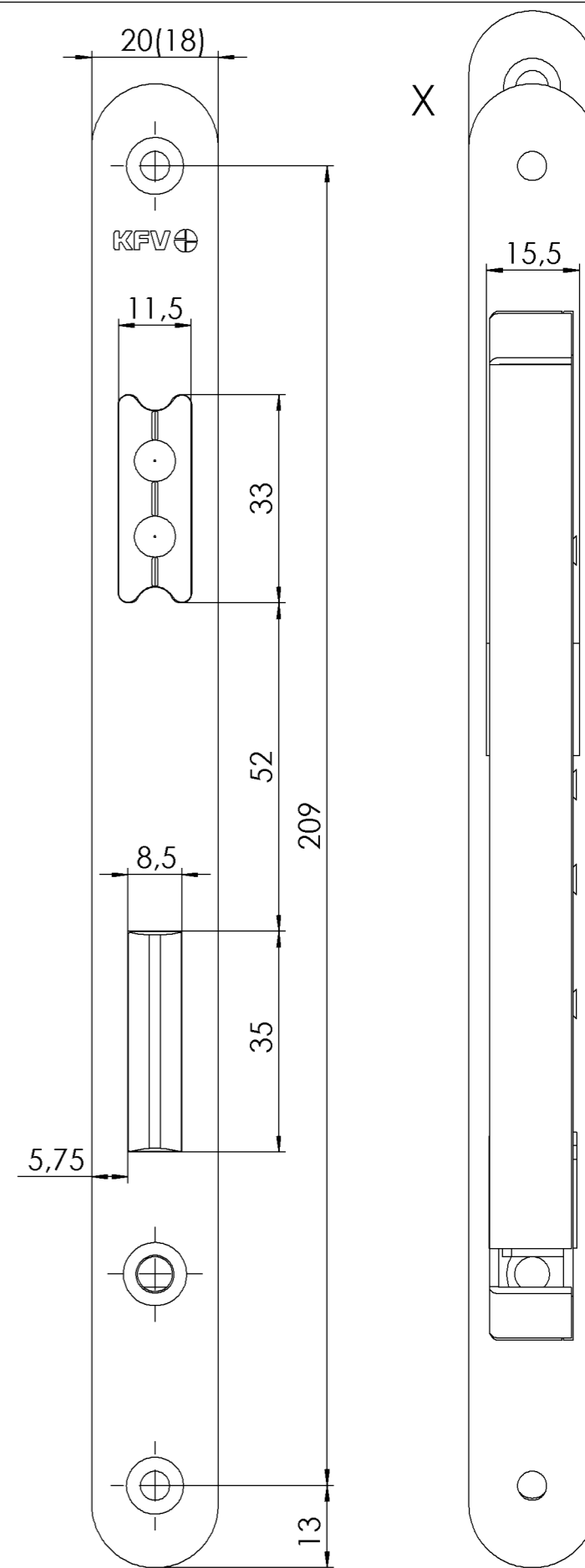
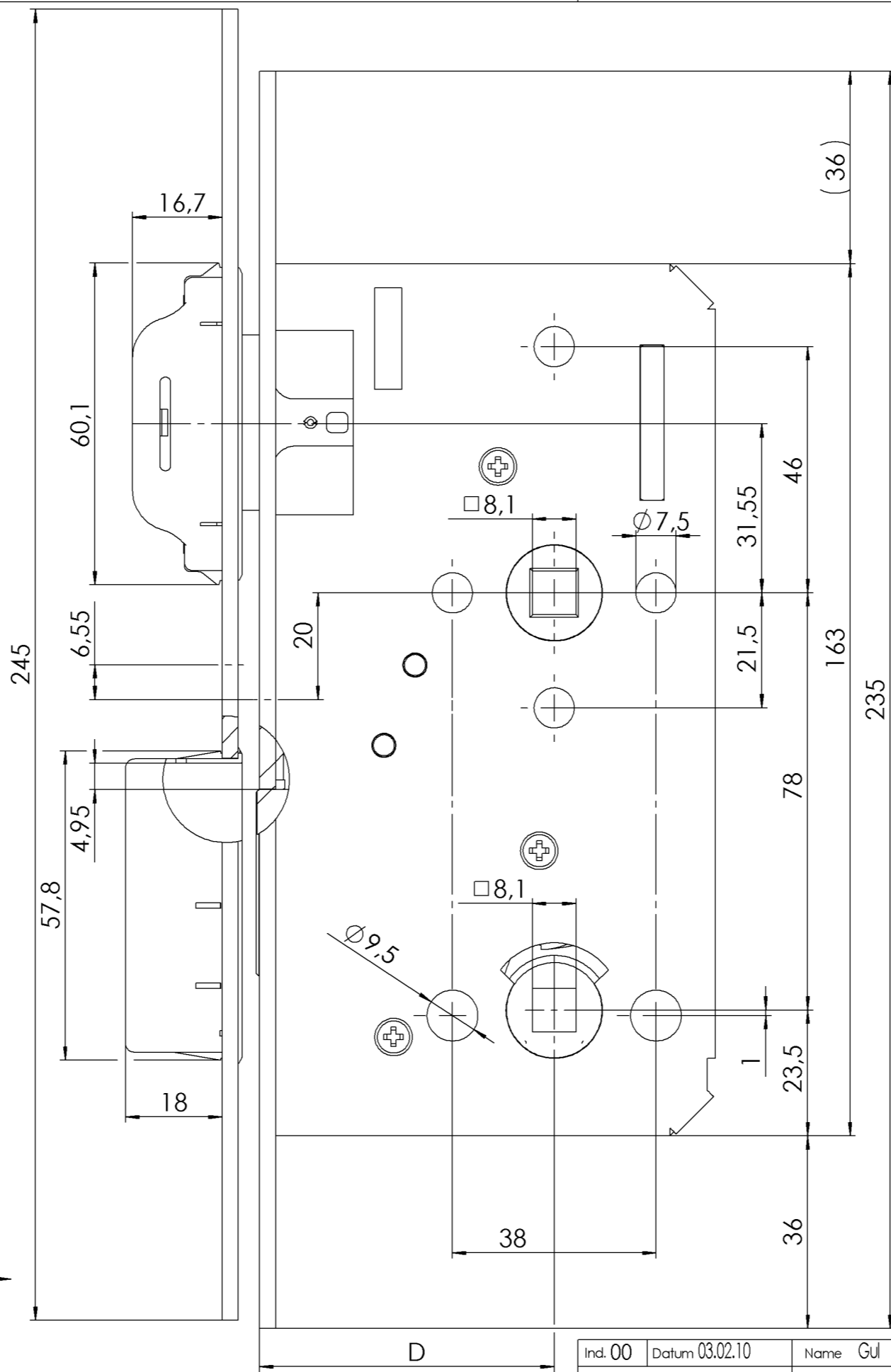
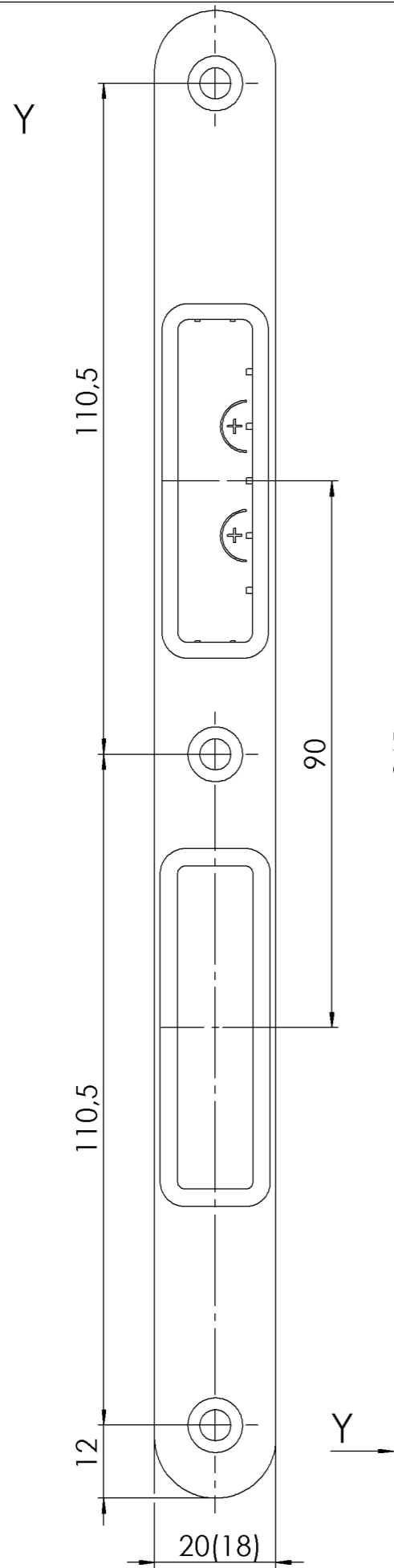
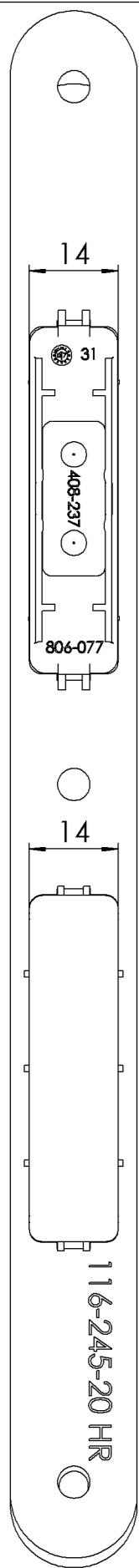

Ind. 00 Datum 03.02.10

Name Gul

Art.-Nr.

KFV
Karl Fliether GmbH & Co
42551 Velbert

Benennung

116 m. 116-245-20HR

Magnetschloss WC
mit Rahmenteil

Zeichnungs-Nr.

0.0116.0003.82